

# Reconnecting a Cracked Internal Wall to an External Cavity Wall using HeliBars

## Method Statement

- Using a twin-bladed, diamond-tipped wall chaser and vacuum attachment, cut slots into the horizontal mortar joints, to the specified depth and at the required vertical spacing. Use a power/hand chisel to continue slots up to the internal corner. Ensure that **NO** mortar is left attached to the exposed brick surfaces in order to provide a good masonry/grout bond.
- Where the slot ends at the internal corner drill a 12mm hole into the adjoining wall as shown.
- Remove ALL dust and mortar from the slots and holes and thoroughly flush with water. Where the substrate is very porous or flushing with water is inappropriate, use Helifix WB Primer. Ensure the slots and holes are damp or primed prior to commencing steps 6 and 7.
- Cut the 6mm HeliBar to the required length and bend the end to fit in the hole, then remove.
- Mix HeliBond cementitious grout using a power mixer and load into the Helifix Pointing Gun Kit CS.
- Fill the hole with HeliBond grout using the pinning nozzle.
- Inject a bead of HeliBond grout, approx. 15mm deep, into the back of the slot using the mortar nozzle.
- Push the HeliBar into the grout to obtain good coverage.
- Inject a second bead of HeliBond grout over the exposed HeliBar and iron it into the slot using a finger trowel. Inject additional HeliBond as necessary, leaving 10-15mm for new pointing.
- Point up or fill the remaining slot, make good the crack and leave ready for any decoration.
- Tie inner and outer leaves together using appropriate Helifix wall ties.

N.B. Pointing may be carried out as soon as is convenient after the HeliBond has started to gel.

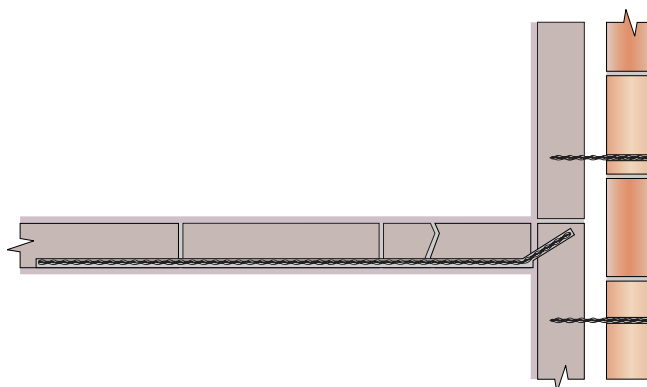

## Recommended Tooling

For cutting slots up to 40mm deep: Hilti DC-SE 20 wall chaser or similar with vacuum attachment.

For drilling: SDS rotary hammer drill 650/700w.

For mixing HeliBond: 3-jaw-chuck drill with mixing paddle.

For injection of HeliBond into slots: Helifix Pointing Gun Kit CS with mortar nozzle.

For injection of HeliBond into holes: Helifix Pointing Gun Kit CS with pinning nozzle.

For smoothing pointing: Standard finger trowel.

## General Notes

If your application differs from this repair detail or you require specific advice on your particular project, call the Helifix Technical Sales Team on 020 8735 5222. Our Technical Department can provide you with a full support service including:

- Advice, assistance and recommendations on all structural repair matters
- Devising and preparing complete repair proposals for specific situations
- An insurance-backed warranty via our Approved Installers scheme

## SPECIFICATION NOTES

The following criteria are to be used unless specified otherwise:

- A** Depth of slot into the masonry to be 25 to 35mm **plus the thickness of the plaster.**
- B** Height of slot to be equal to full mortar joint height, with a minimum of 8mm. For thin mortar joint specifications refer to the Helifix Technical Dept.
- C** HeliBar to be long enough to extend a minimum of 500mm either side of the crack or 500mm beyond the outer cracks if two or more adjacent cracks are being stitched using one rod.
- D** Normal vertical spacing is 450mm.
- E** Wall ties to be inserted at 225mm vertical spacing, 225mm back from the junction, and staggered on alternate sides of the junction.
- F** In hot conditions ensure the masonry is well wetted or primed to prevent premature curing of the HeliBond due to rapid de-watering. Ideally additional wetting of the slot, or priming with Helifix WB primer, should be carried out just prior to injecting the HeliBond grout.
- G** Do not use HeliBond grout when the air temperature is +4°C and falling or apply over ice. In all instances the slot must be thoroughly damp or primed prior to injection of the HeliBond grout.

The above specification notes are for general guidance only and Helifix reserves the right to amend details/notes as necessary.