

Crack Stitching a Rendered Cavity Wall using HeliBars

CS02

Method Statement

1. Using a twin-bladed, diamond-tipped wall chaser and vacuum attachment, cut horizontal slots into the brickwork, to the specified depth and at the required vertical spacing.
2. Remove ALL dust and mortar from the slots and thoroughly flush with water. Where the substrate is very porous or flushing with water is inappropriate, use Helifix WB Primer. Ensure the slot is damp or primed prior to commencing step 4.
3. Mix HeliBond cementitious grout using a power mixer and load into the Helifix Pointing Gun Kit CS.
4. Inject a bead of HeliBond grout, approx. 15mm deep, into the back of the slot.
5. Push the 6mm HeliBar into the grout to obtain good coverage.
6. Inject a second bead of HeliBond grout over the exposed HeliBar and iron it into the slot using a finger trowel. Inject additional HeliBond as necessary, leaving 10-15mm for making good the render.
7. The crack within the render should be made good using an appropriate Helifix bonding agent depending on the width of the crack or leave ready for any decoration.

N.B. Making good of the render may be carried out as soon as is convenient after the HeliBond has started to gel.

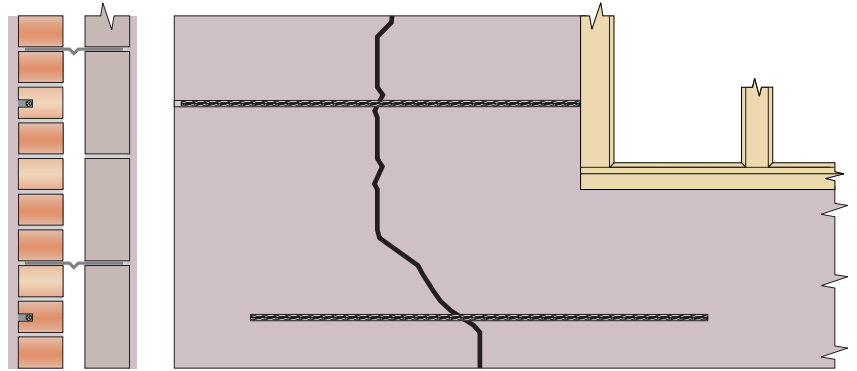

Recommended Tooling

For cutting slots up to 40mm deep: Hilti DC-SE 20 wall chaser or similar with vacuum attachment.

For cutting slots more than 40mm deep: Twin bladed cutter with vacuum attachment.

For mixing HeliBond: 3-jaw-chuck drill with mixing paddle.

For injection of HeliBond into slots: Helifix Pointing Gun Kit CS with mortar nozzle.

For smoothing pointing: Standard finger trowel.

General Notes

If your application differs from this repair detail or you require specific advice on your particular project, call the Helifix Technical Sales Team on 020 8735 5222. Our Technical Department can provide you with a full support service including:

- Advice, assistance and recommendations on all structural repair matters
- Devising and preparing complete repair proposals for specific situations
- An insurance-backed warranty via our Approved Installers scheme

SPECIFICATION NOTES

The following criteria are to be used unless specified otherwise:

- A** The slot in the masonry is to be 25mm to 35mm, **plus the thickness of the render**, by 10mm high.
- B** HeliBar to be long enough to extend a minimum of 500mm either side of the crack or 500mm beyond the outer cracks if two or more adjacent cracks are being stitched using one rod.
- C** Normal vertical spacing is 450mm (6 brick courses).
- D** Where a crack is less than 500mm from the end of a wall or an opening the HeliBar is to be continued for at least 100mm around the corner and bonded into the adjoining wall or bent back and fixed into the reveal, avoiding any DPC.
- E** In hot conditions ensure the masonry is well wetted or primed to prevent premature curing of the HeliBond due to rapid de-watering. Ideally additional wetting of the slot, or priming with Helifix WB primer, should be carried out just prior to injecting the HeliBond grout.
- F** Do not use HeliBond when the air temperature is +4°C and falling or apply over ice. In all instances the slot must be thoroughly damp or primed prior to injection of the HeliBond grout.

The above specification notes are for general guidance only and Helifix reserves the right to amend details/notes as necessary.