

Method Statement

Floor joists perpendicular to the bay front

1. Mark the positions of joists on the external wall.
2. Drill clearance hole (normally 12mm) through the masonry in line with the centre of the joists. Clean any dust or debris from the hole.
3. Insert the BowTie power support tool into an SDS rotary hammer drill and place the BowTie into the support tool. Drive the BowTie into the timber to the required depth.
4. Place the sleeve over the tie and push it to the back of the hole in the outer leaf masonry (use the power support tool).
5. Inject Helifix PolyPlus Resin to fill the hole completely. Allow the resin to gel (normally 15 to 20 minutes).
6. Make good all holes at the surface with brick dust or matching mortar or leave ready for any decoration.

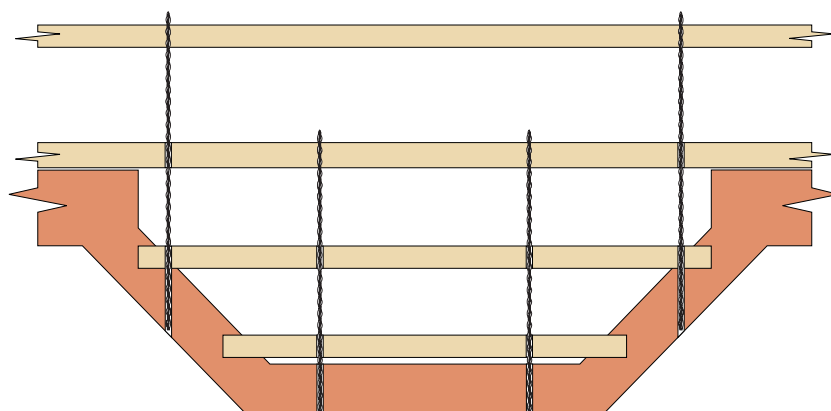
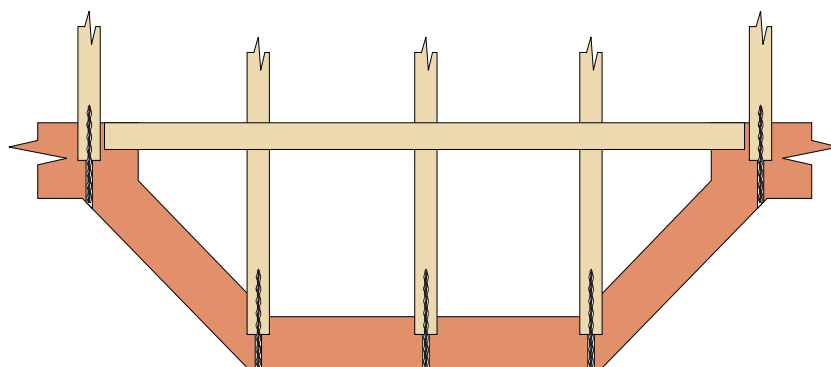

Floor joists parallel to the bay front

1. Mark the positions for the BowTie clearance holes on the external wall.
2. Drill clearance hole (normally 12mm) through the masonry in line with the centre of the joists. Ensure that the hole lines up with the joist and continue to drill through the first and second joists as pictured. Clean out the hole to clear any dust or debris.
3. Fit the BowTie power support tool into an SDS rotary hammer drill and insert the BowTie into the support tool. Drive the BowTie into, and through, the third joist.
4. Place the sleeve over the tie and push it to the back of the hole in the outer leaf masonry (use the power support tool).
5. Inject Helifix PolyPlus Resin to fill the hole completely. Allow the resin to gel (normally 15 to 20 minutes).
6. Make good all holes at the surface with brick dust or matching mortar or leave ready for any decoration.

N.B. Ensure ceiling void is free of pipes and cables.

Recommended Tooling

For drilling: SDS rotary hammer drill 650/700w.

For installation of BowTies: BowTie support tool.

For injection of PolyPlus resin: Applicator gun with nozzle.

General Notes

If your application differs from this repair detail or you require specific advice on your particular project, call the Helifix Technical Sales Team on 020 8735 5222. Our Technical Department can provide you with a full support service including:

- Advice, assistance and recommendations on all structural repair matters
- Devising and preparing complete repair proposals for specific situations
- An insurance-backed warranty via our Approved Installers scheme

SPECIFICATION NOTES

The following criteria are to be used unless specified otherwise:

- A** Minimum penetration into the timber is 50mm for side grain and 75mm for end grain.
- B** For joists perpendicular to the bay front, each joist in the area of concern is to be secured with a BowTie (i.e. spacing of BowTies is to correspond with the original joist spacing).
- C** Ensure that all joists into which BowTies are to be installed are both sound and secure.
- D** For joists parallel to the bay front, maximum horizontal spacing is 600mm between ties.

The above specification notes are for general guidance only and Helifix reserves the right to amend details/notes as necessary.